

Building the Tabernacle

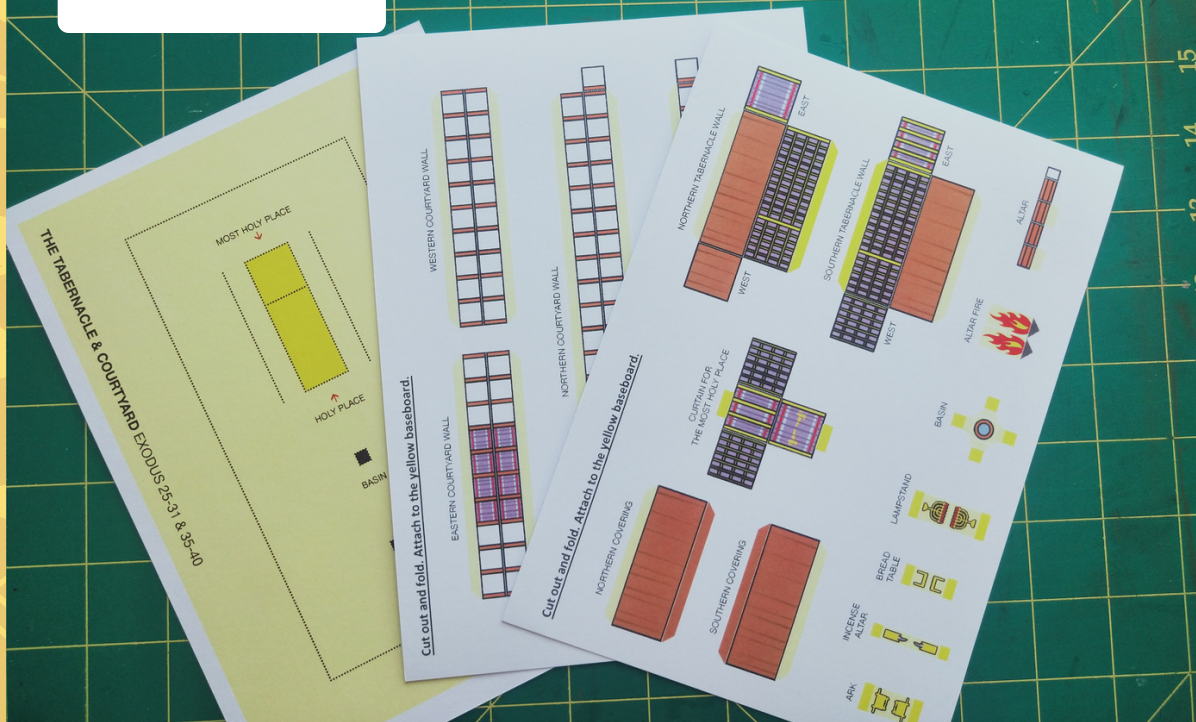

You will need an adhesive like glue, double-sided tape or glue dots. I used pva glue.



You will need also need scissors, a ruler, and a blunt table knife. **Ask your parent's permission before using these items.**



Start by cutting out the walls.

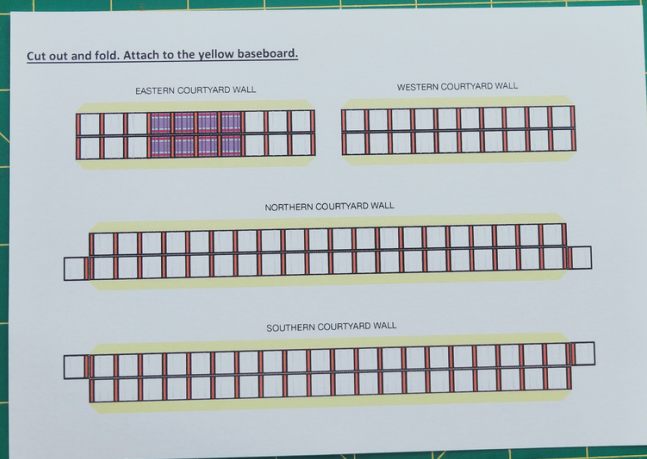

The walls fold in half along the middle line.

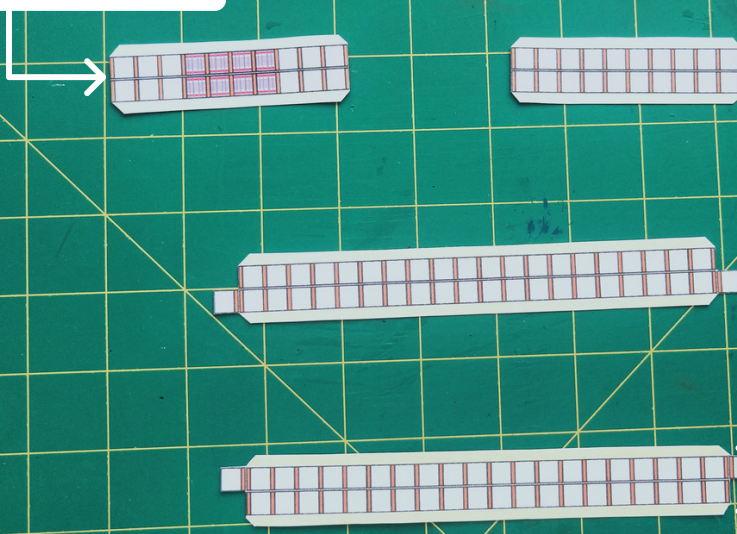

The yellow tabs will fold out like feet.

Using the ruler as a guide, press the back side of the knife hard along each edge that you will fold.

You are making a dent in the paper so it is easier to fold in the right place.

This is called 'scoring'

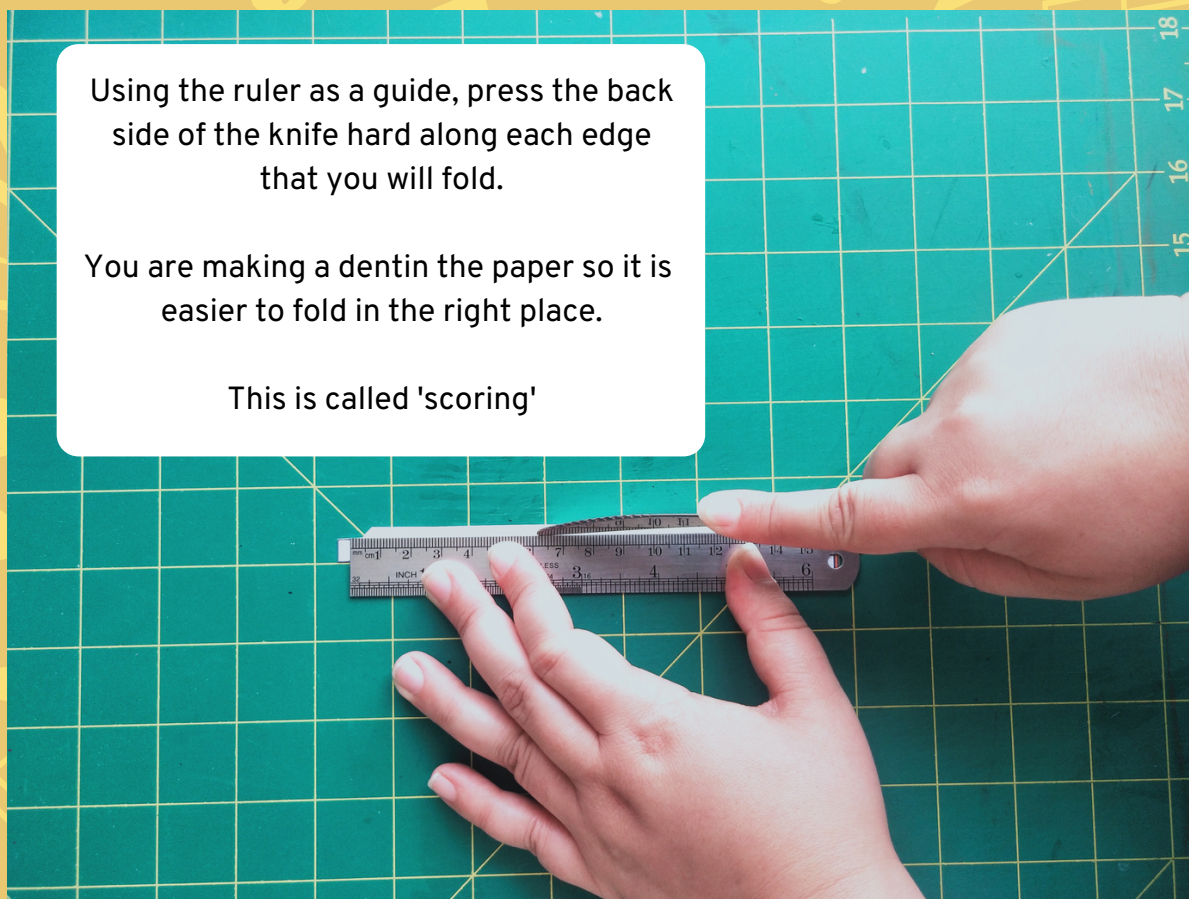

If you can feel the dents on the back of the paper you've done it right.

Bit hard to see but I've scored it right here.

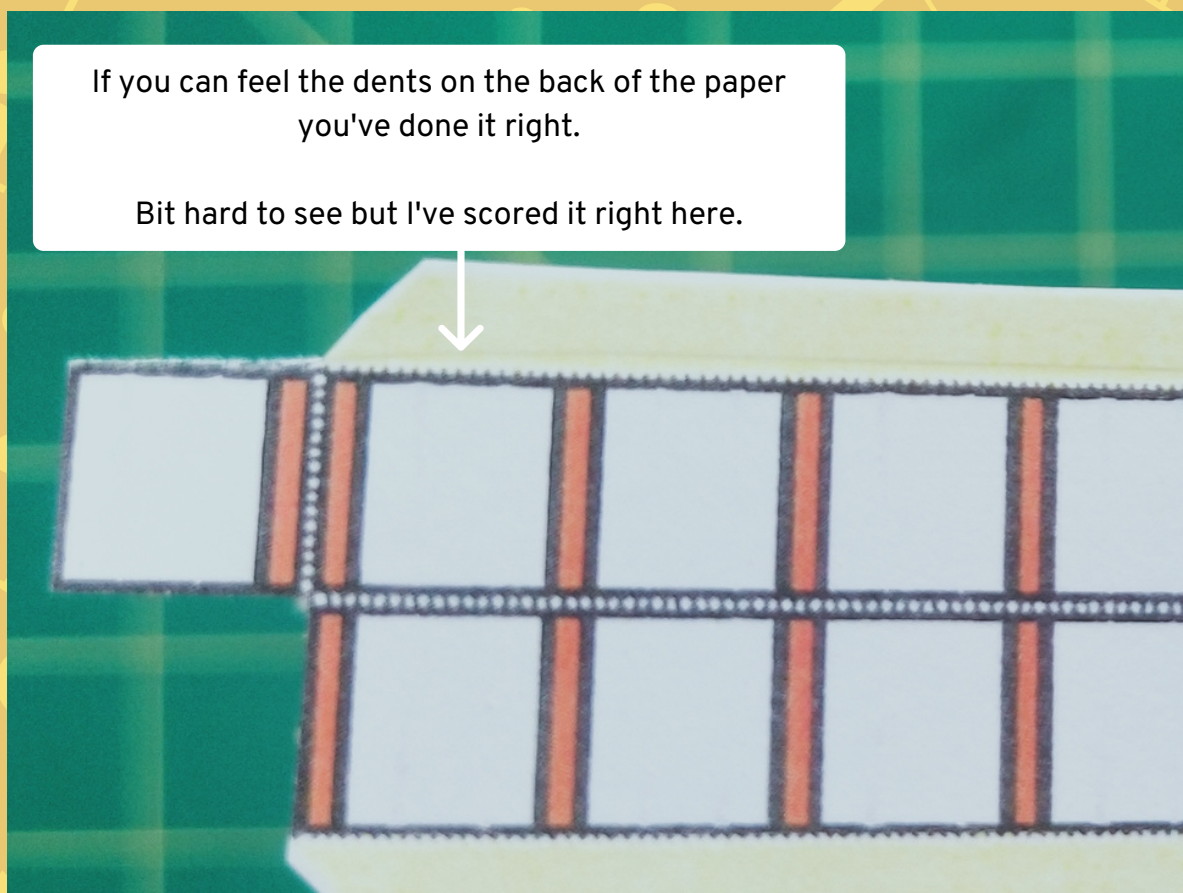

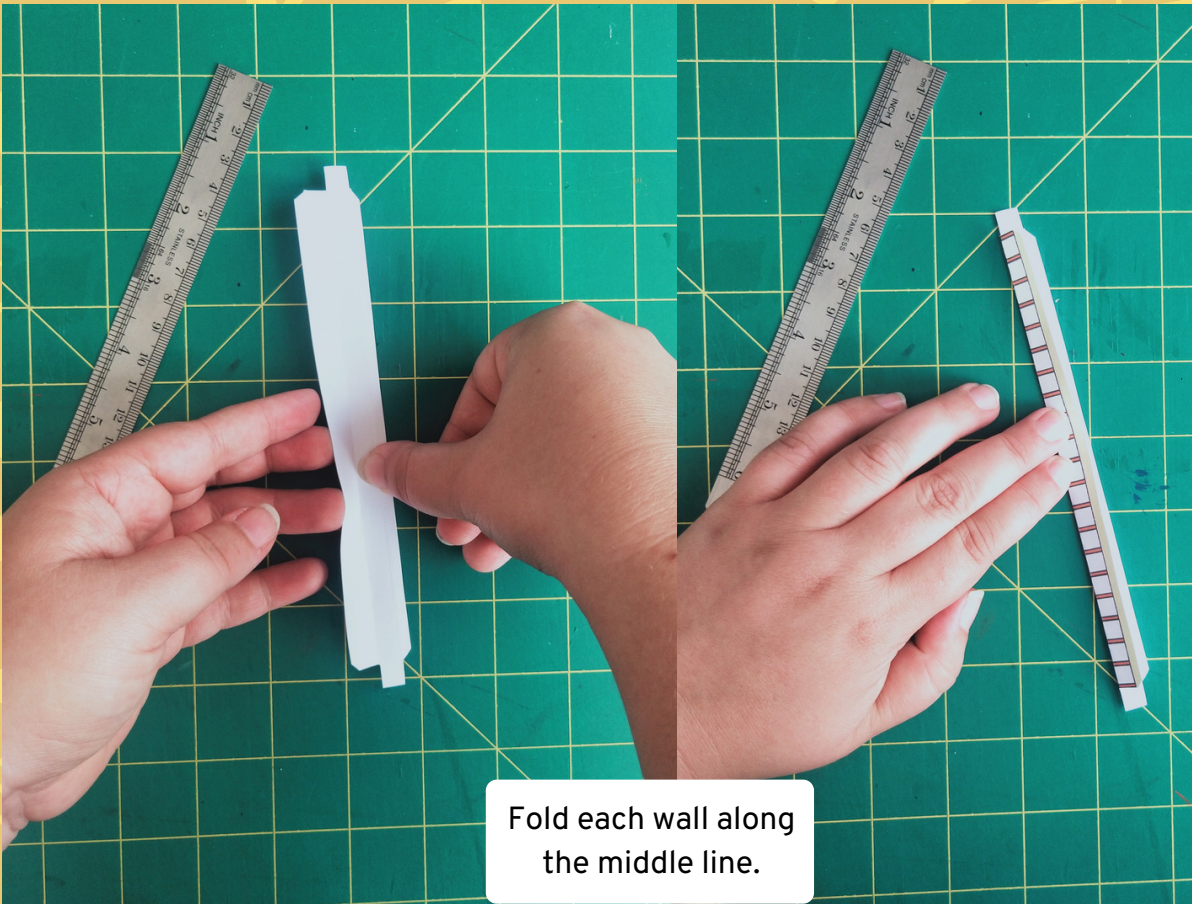

Glue the middle and
press together.

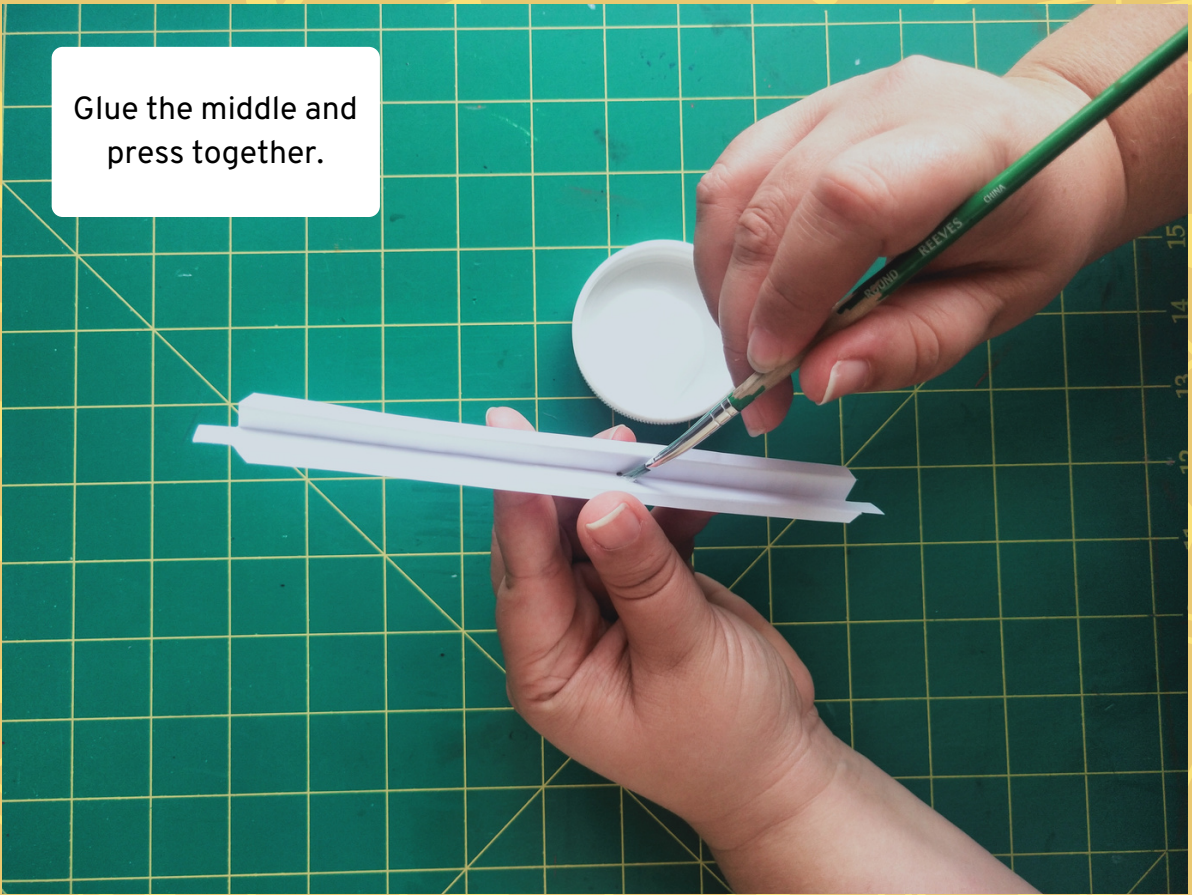

The 2 long walls have an
extra tab at each end.
Fold these at a 90 degree
angle.

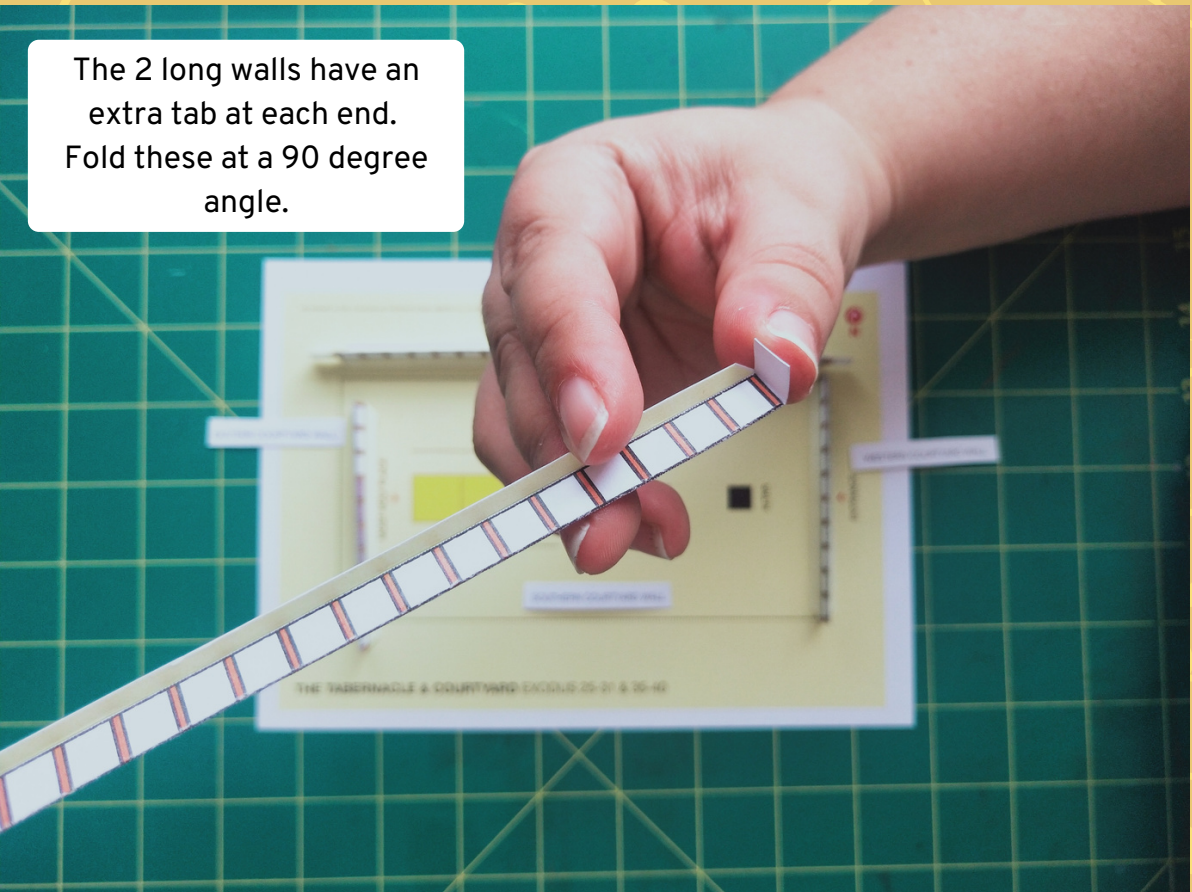

Using those tabs, glue the 4 walls together to make a rectangle.

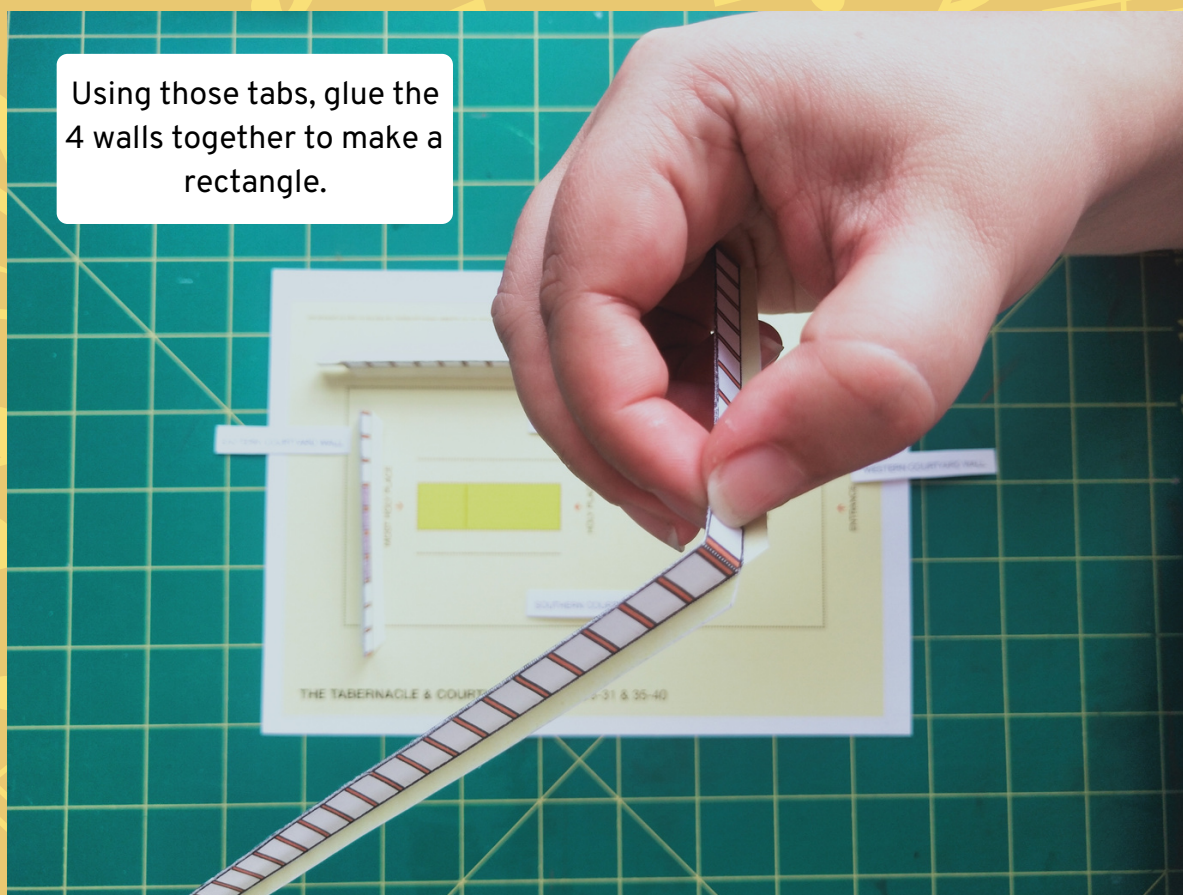

Put glue on the bottom of the rectangle.

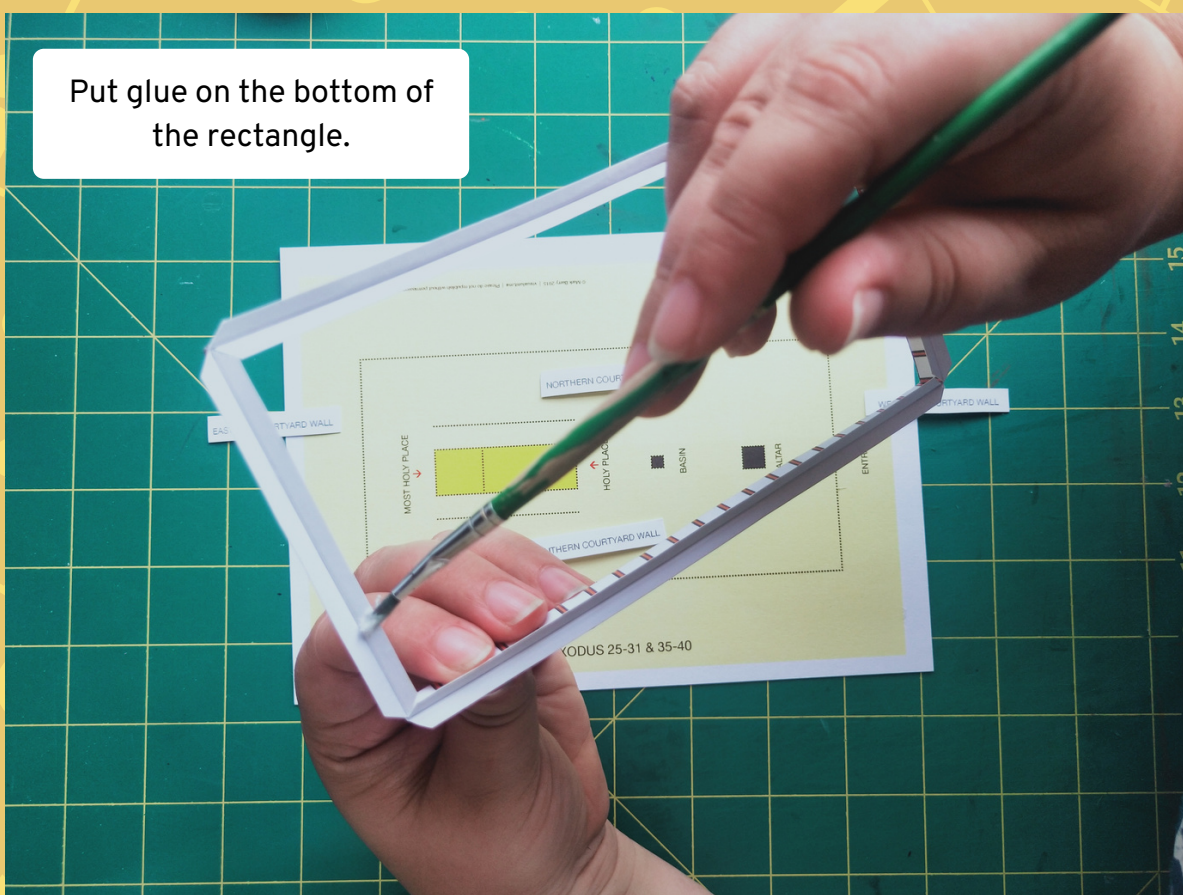

Carefully place the walls onto the yellow baseboard.
The purple section is the entrance.
Lightly press down until it the glue has dried slightly, about 50 seconds.

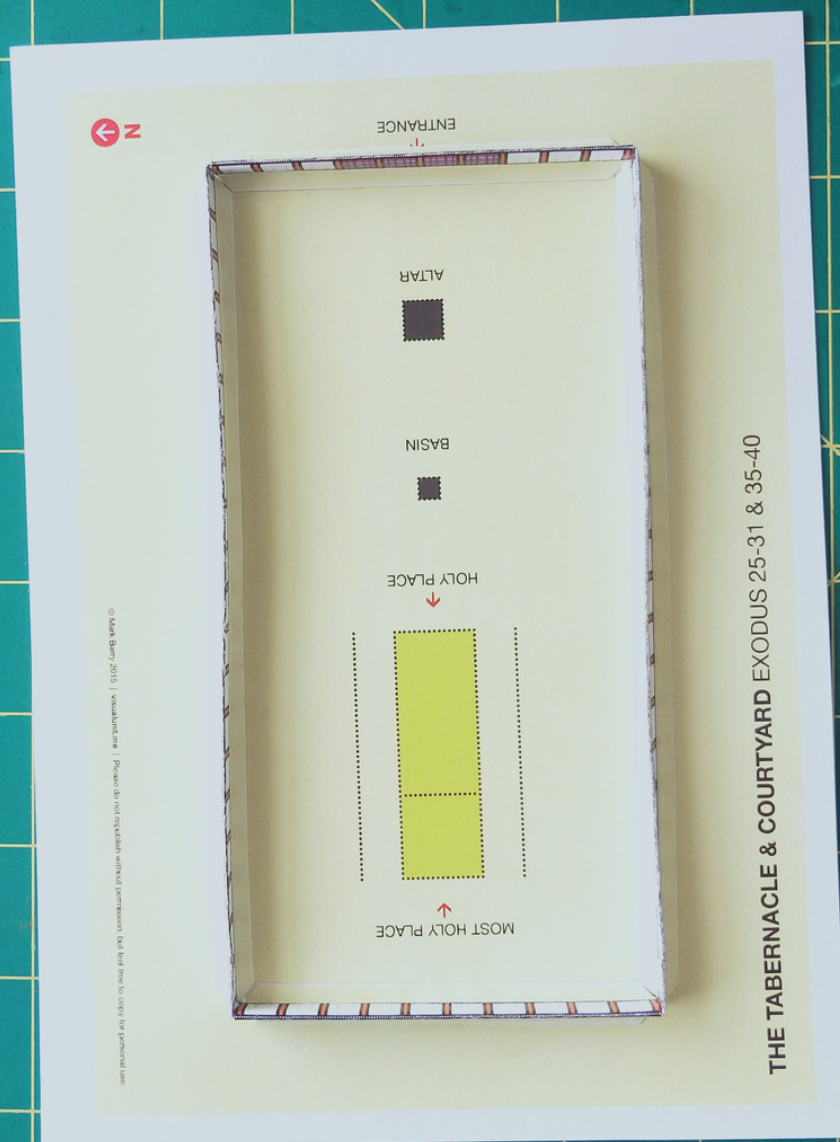

Cut out the tabernacle curtains and items.

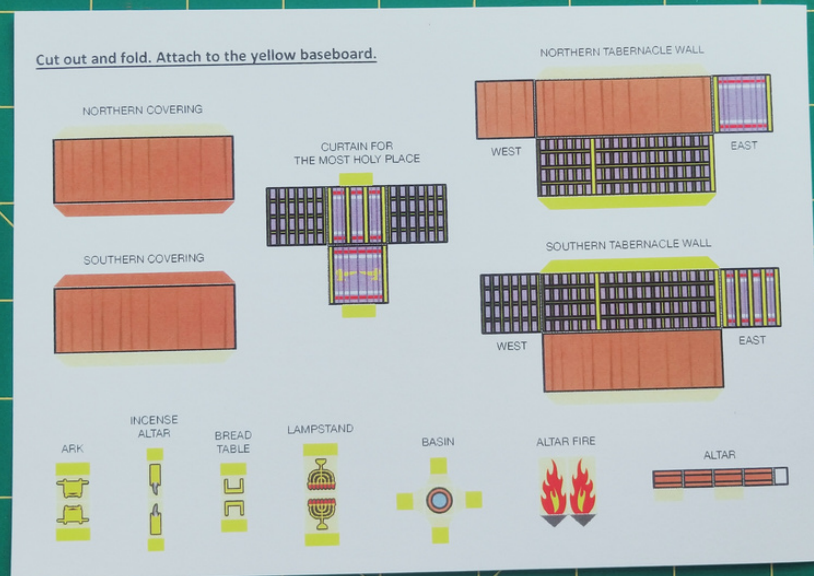

The light and bright yellow are the tabs which will act like feet.

The dotted lines show where to fold.

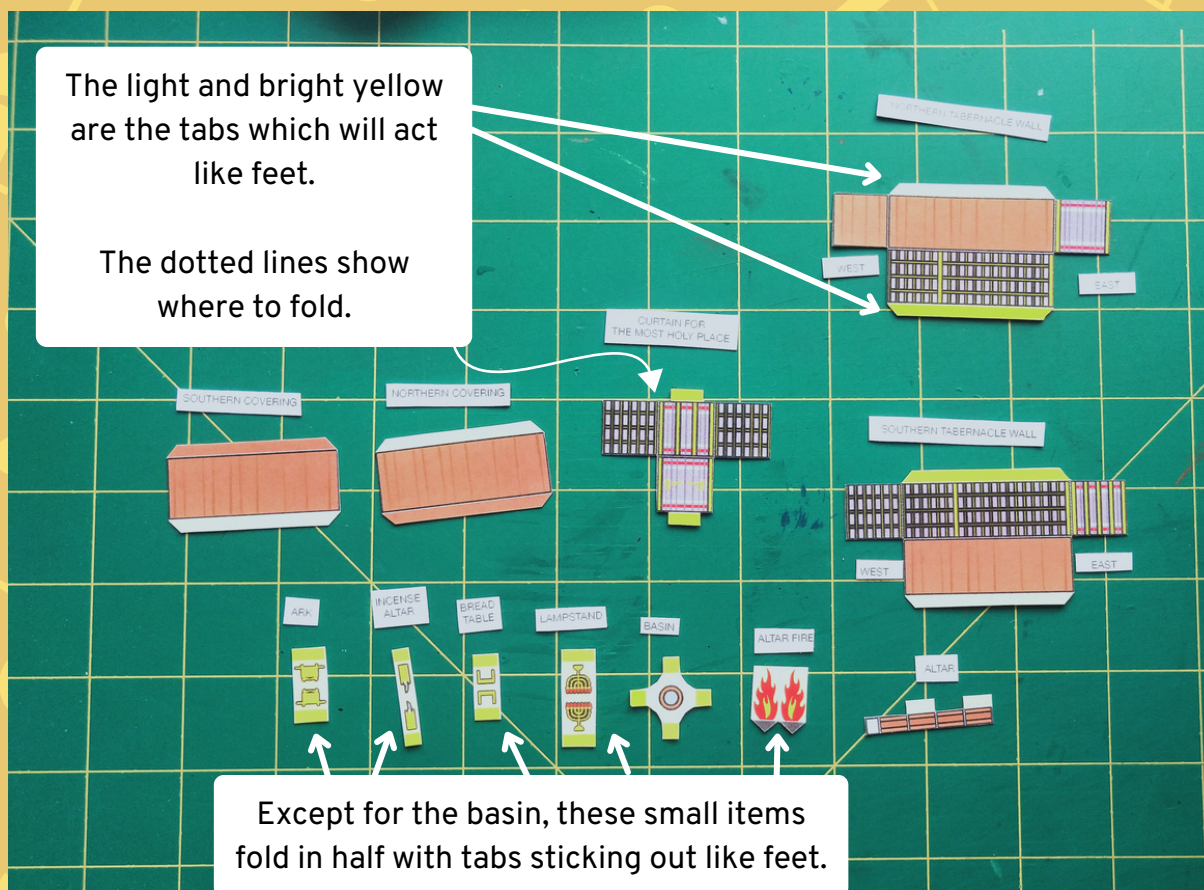

Except for the basin, these small items fold in half with tabs sticking out like feet.

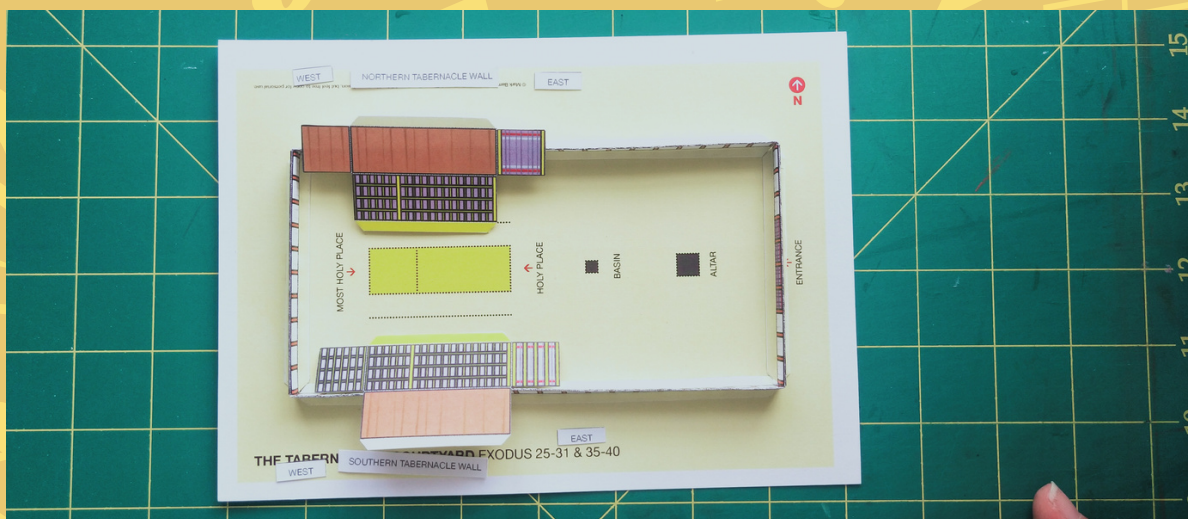

Like with the walls, fold the north and south curtains in half. Fold out the tabs.

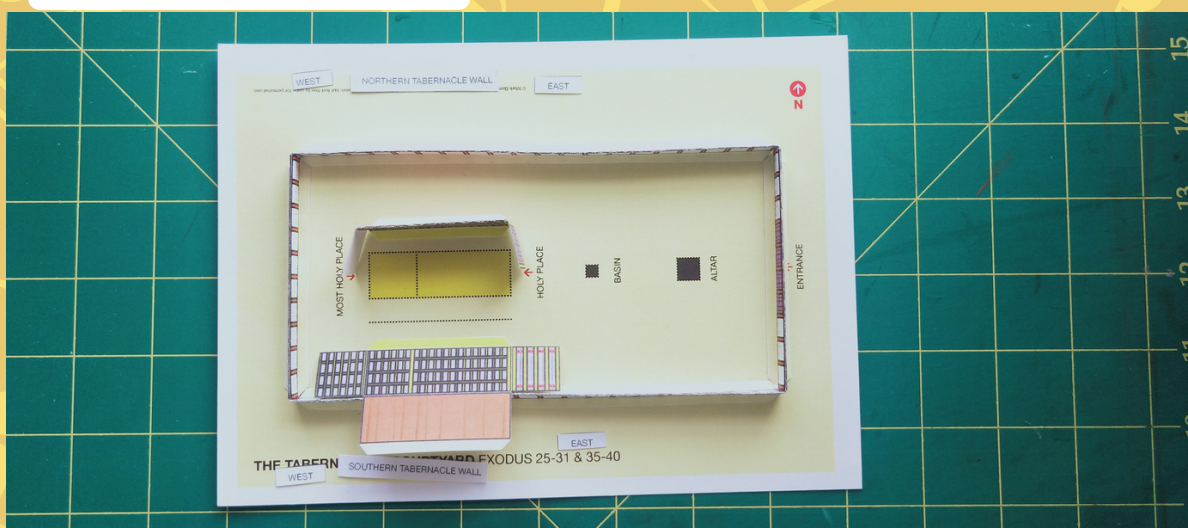

Place glue on the inside and press together.

Bend the tabs on each side to 90 degrees.

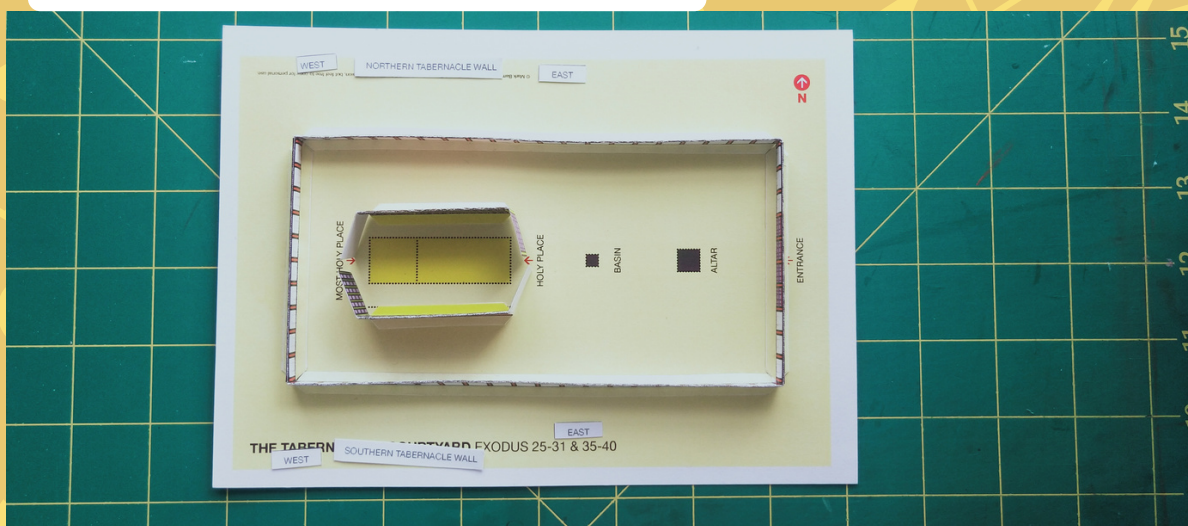

The southern curtain tabs go on
the inside.
The northern curtain tabs go on
the outside.

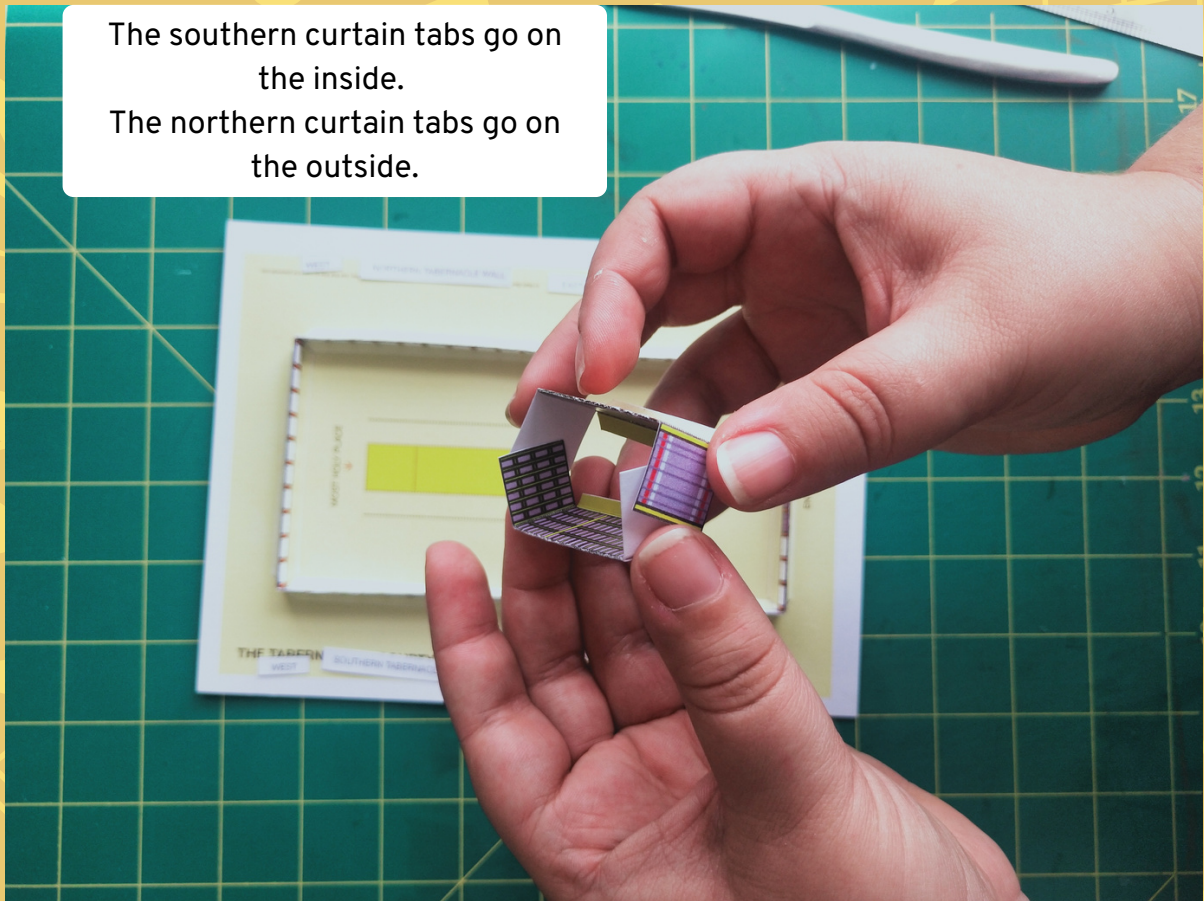

Glue together and then glue
to the baseboard.

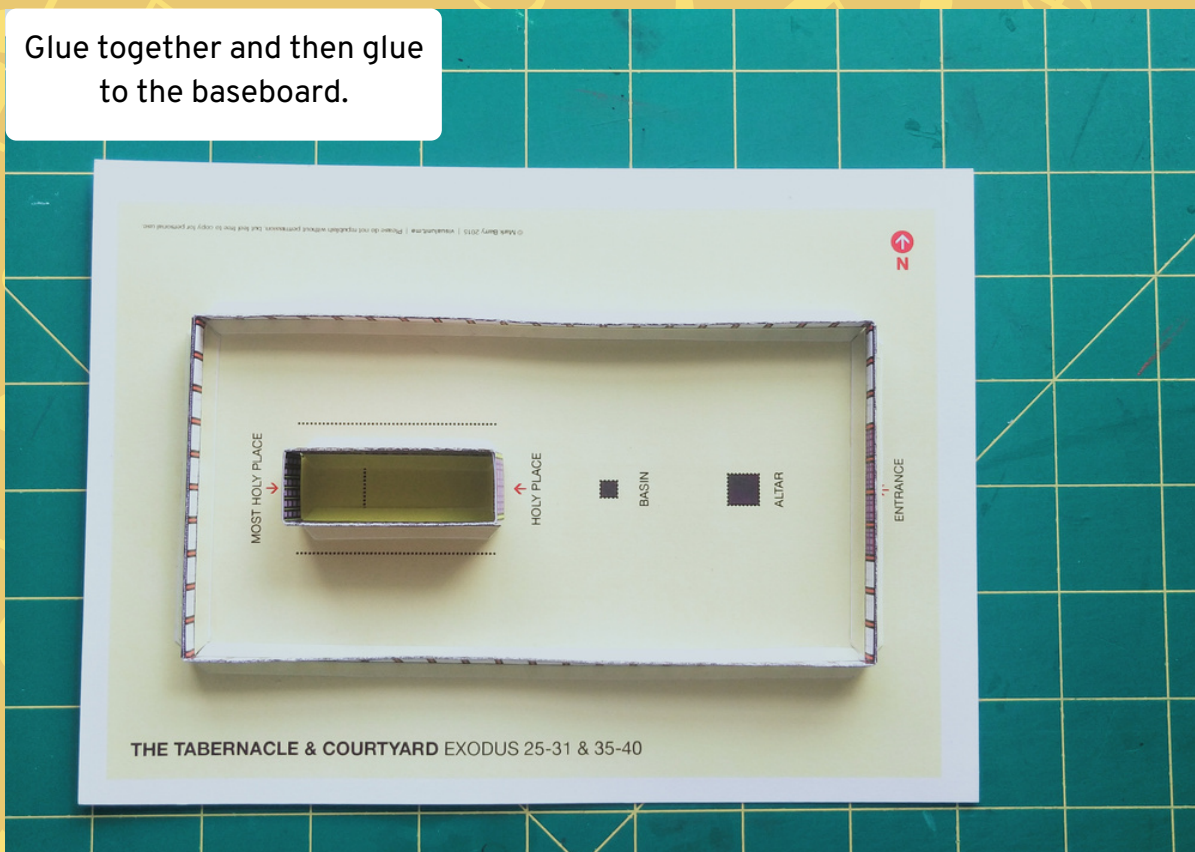

For the curtain for the Most Holy Place: fold in half, fold out the tabs. Glue the inside and press together.

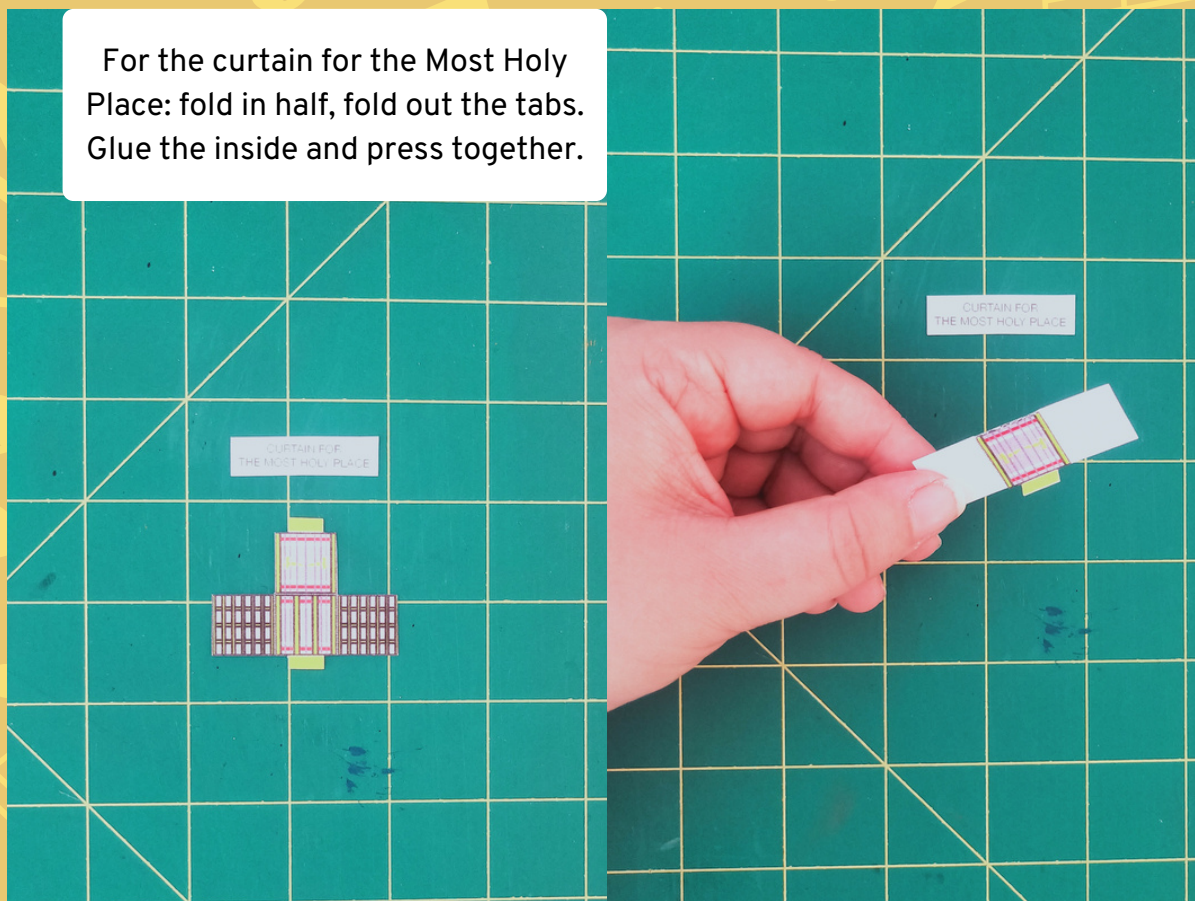

Fold the tabs on the side to 90 degrees.

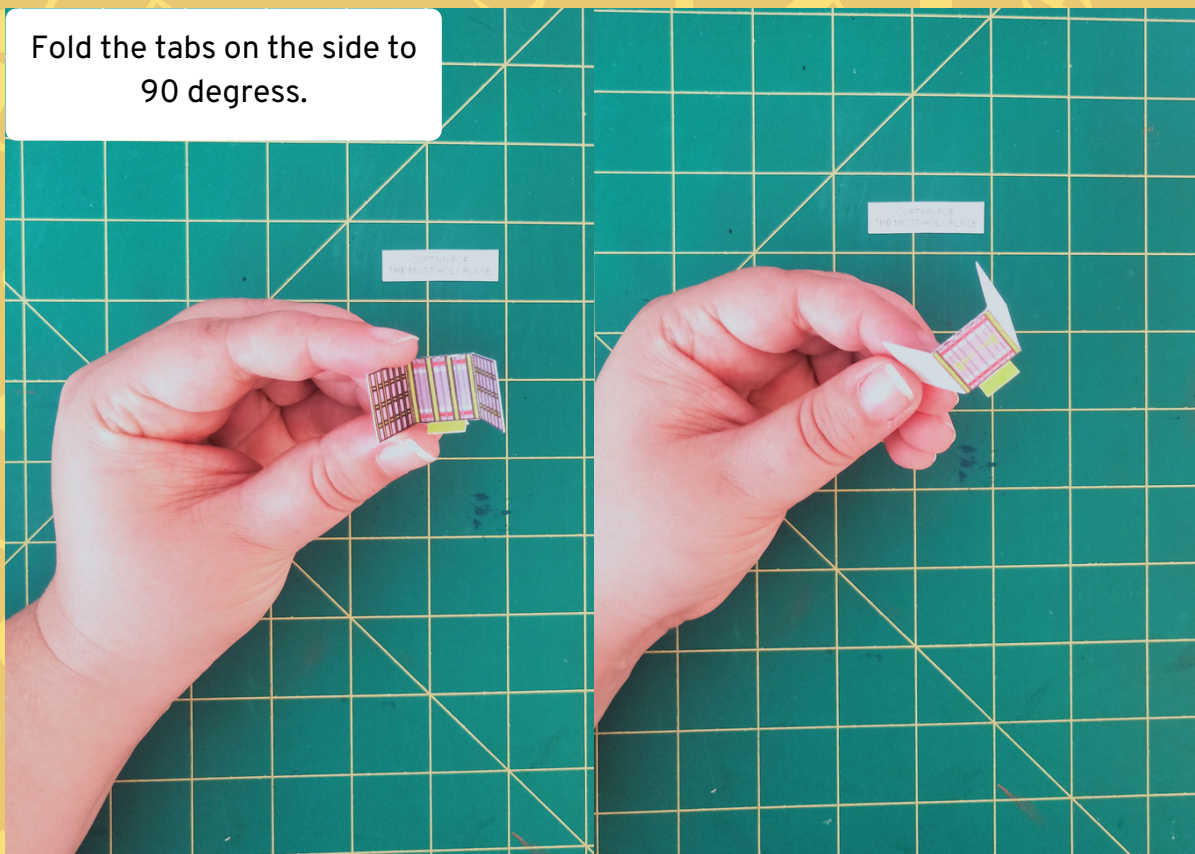

Glue the underneath of the yellow tabs and the white sides of the side tabs.
Place inside the rectangle curtain.

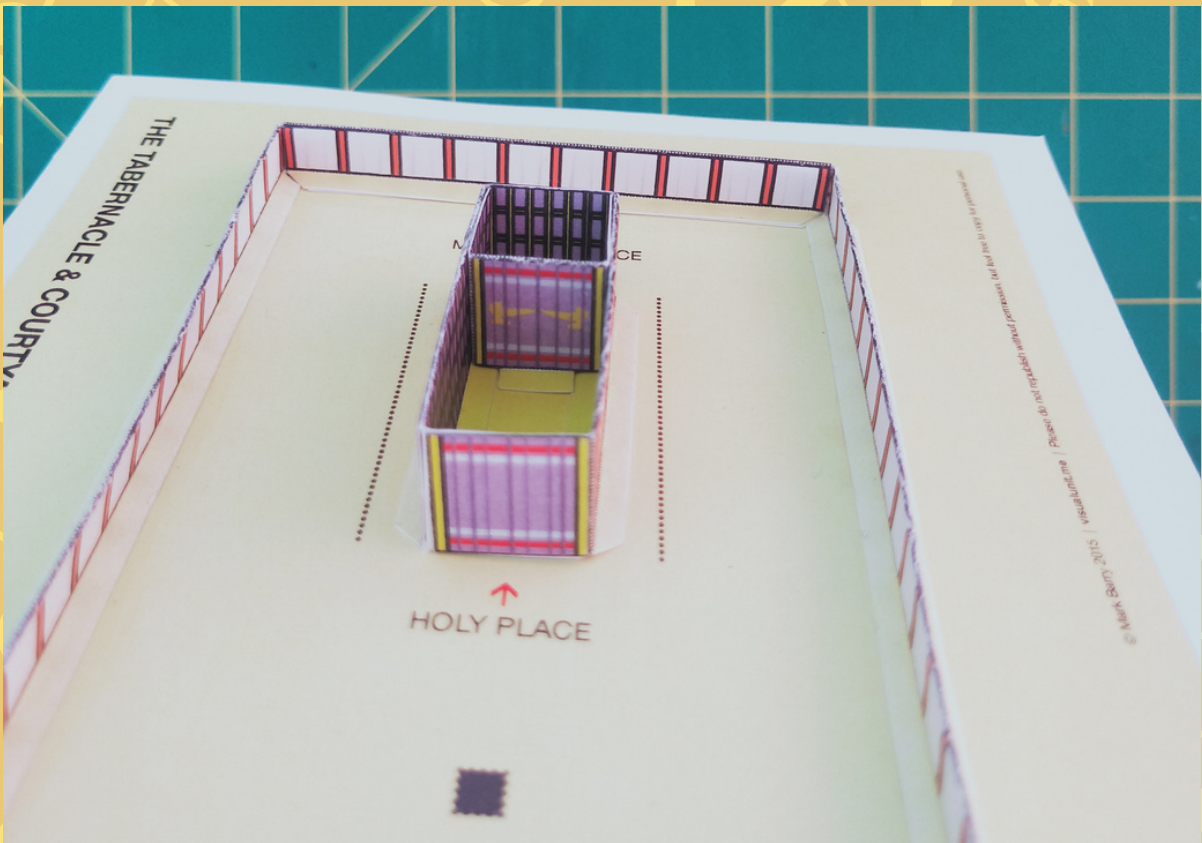
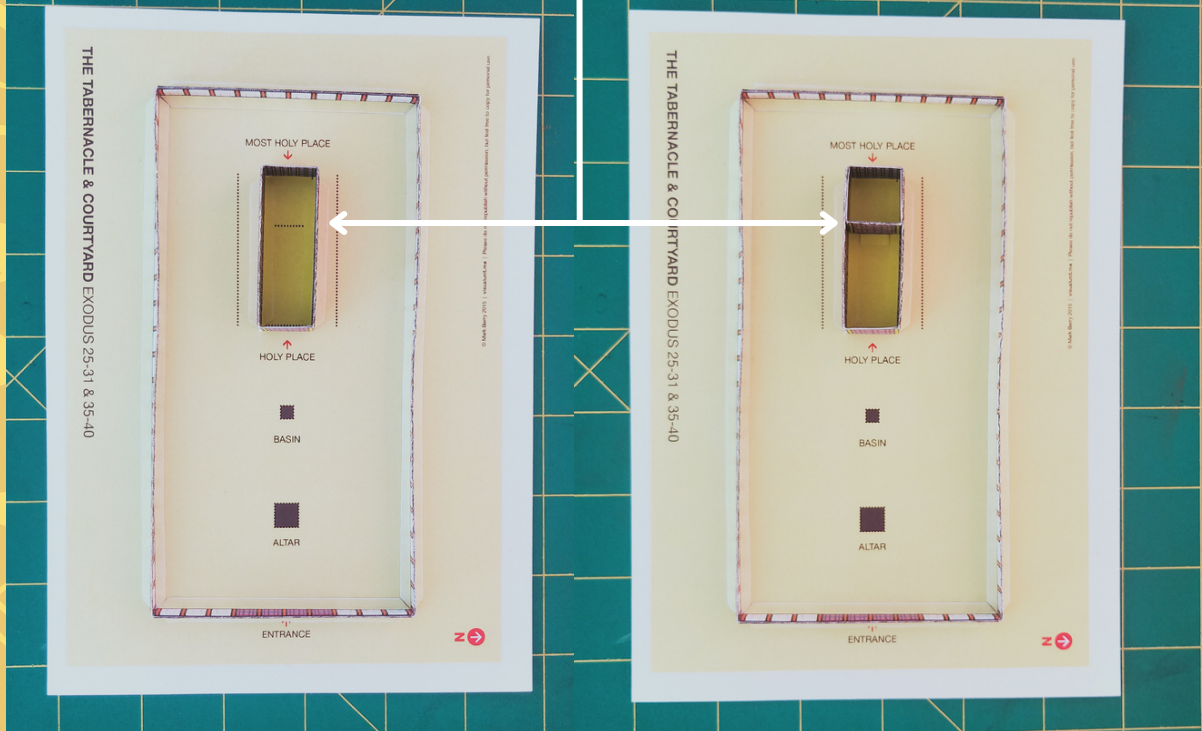

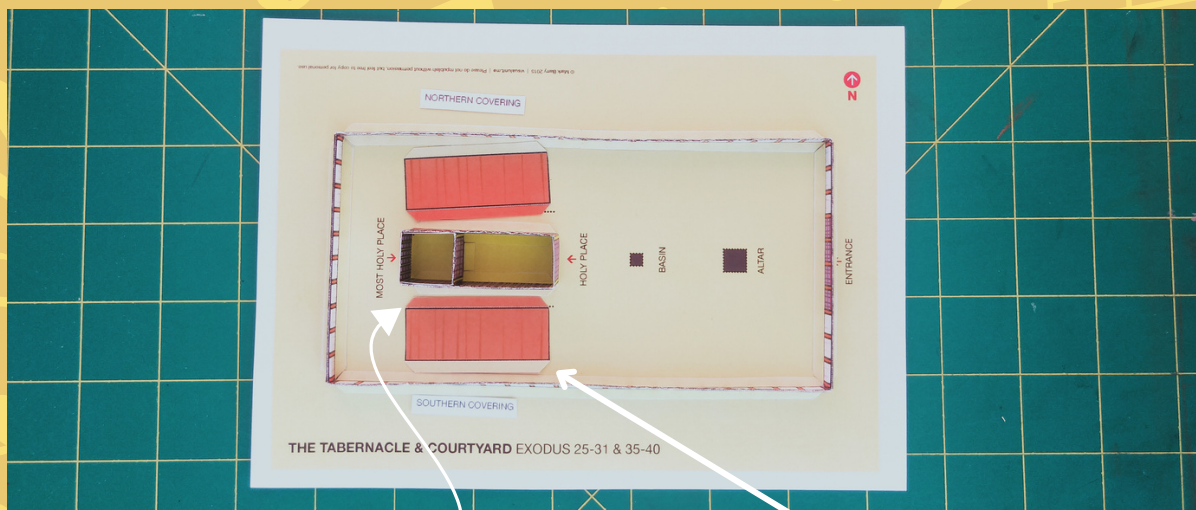

For the outer curtains, fold the brown tab inward and the yellow tab outward.

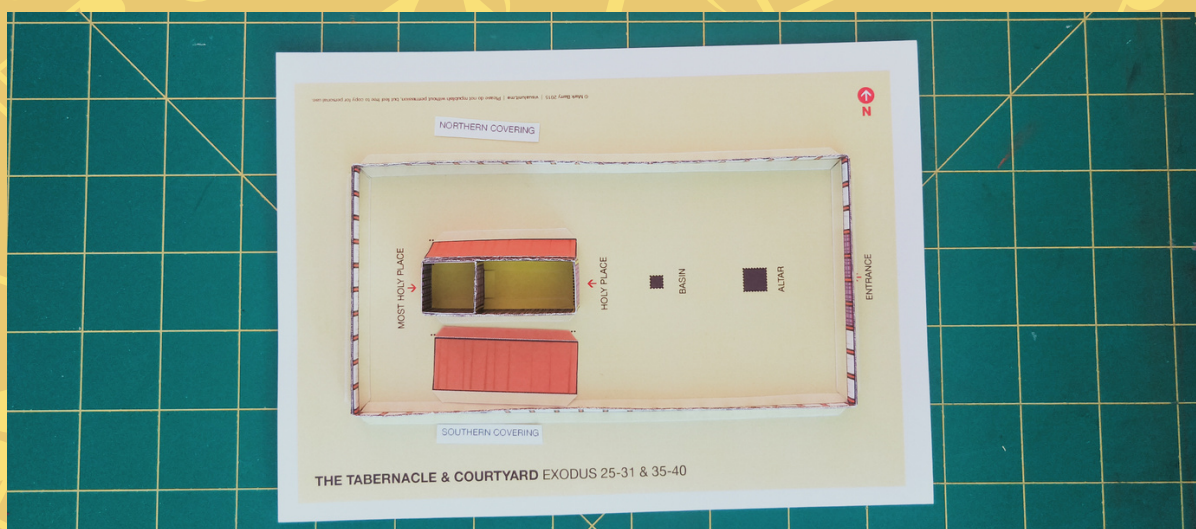

Place glue on the brown side of the brown tab. Place glue on the white side of the yellow tab.
Place at an angle against the side of the rectangle.

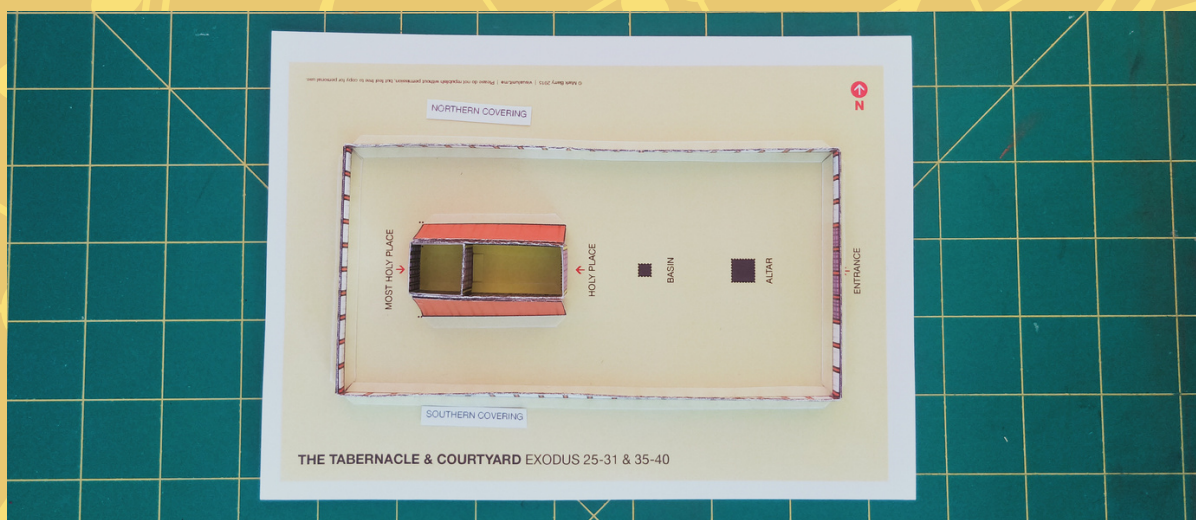

Now for all the small items.

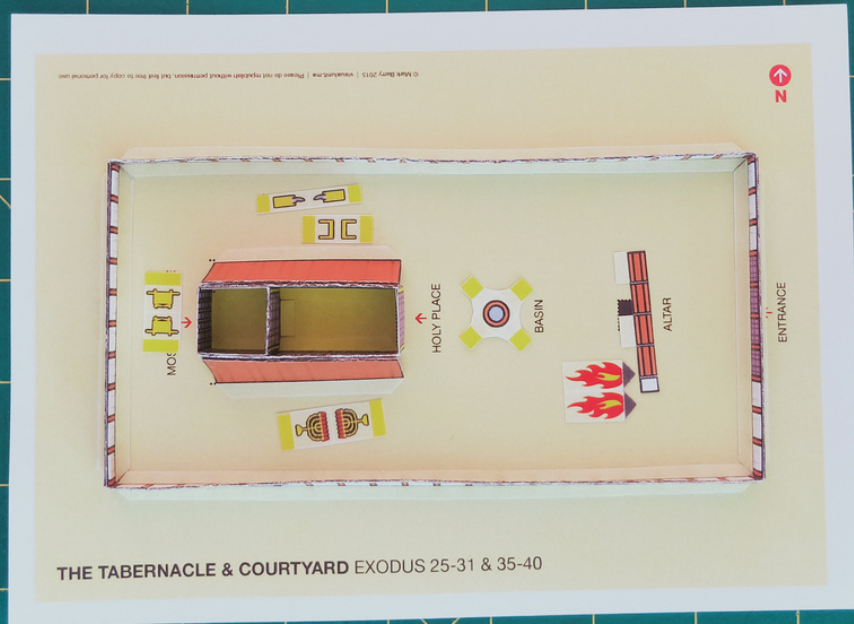

For the ark, the lampstand, the table, and the incense: fold them in half and fold out the tabs.



Glue the insides and press together.

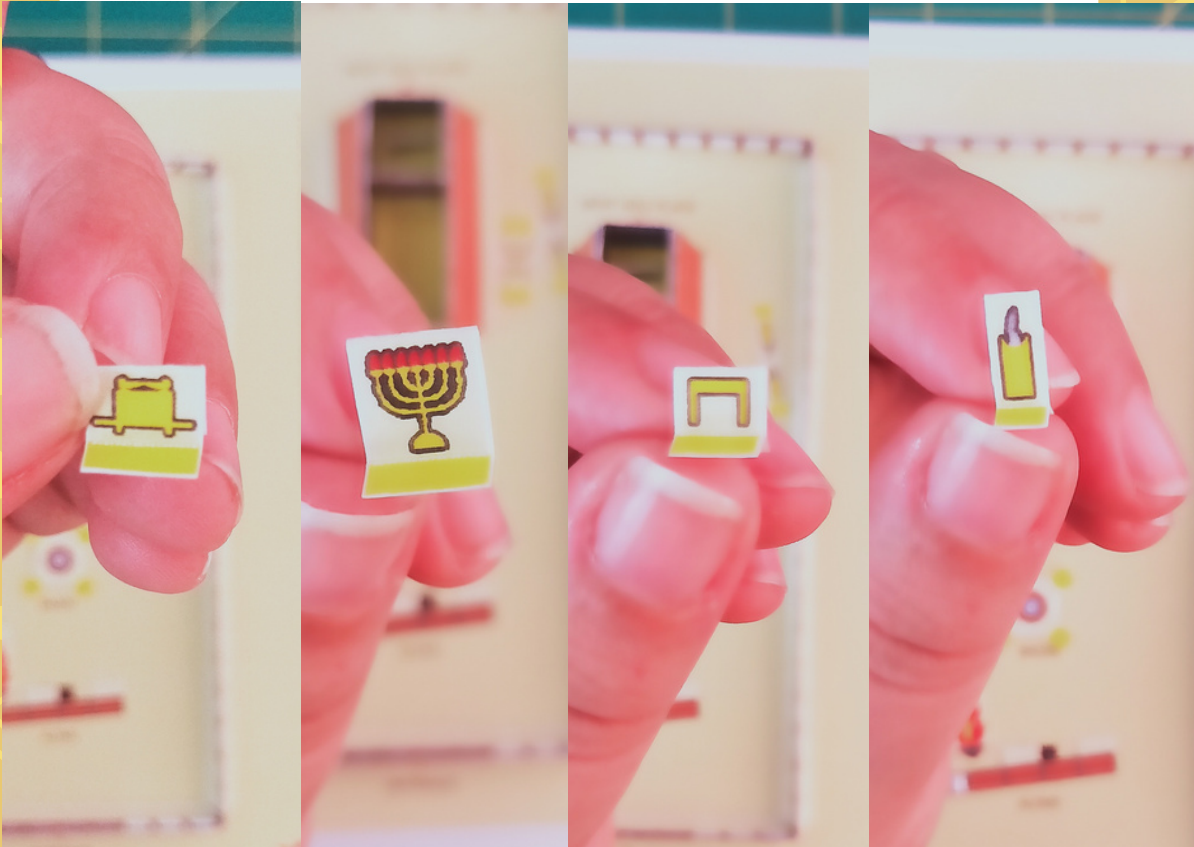

Glue the underside of the yellow tabs. Place inside the Holy Place and Most Holy Place. You may need to use tweezers.

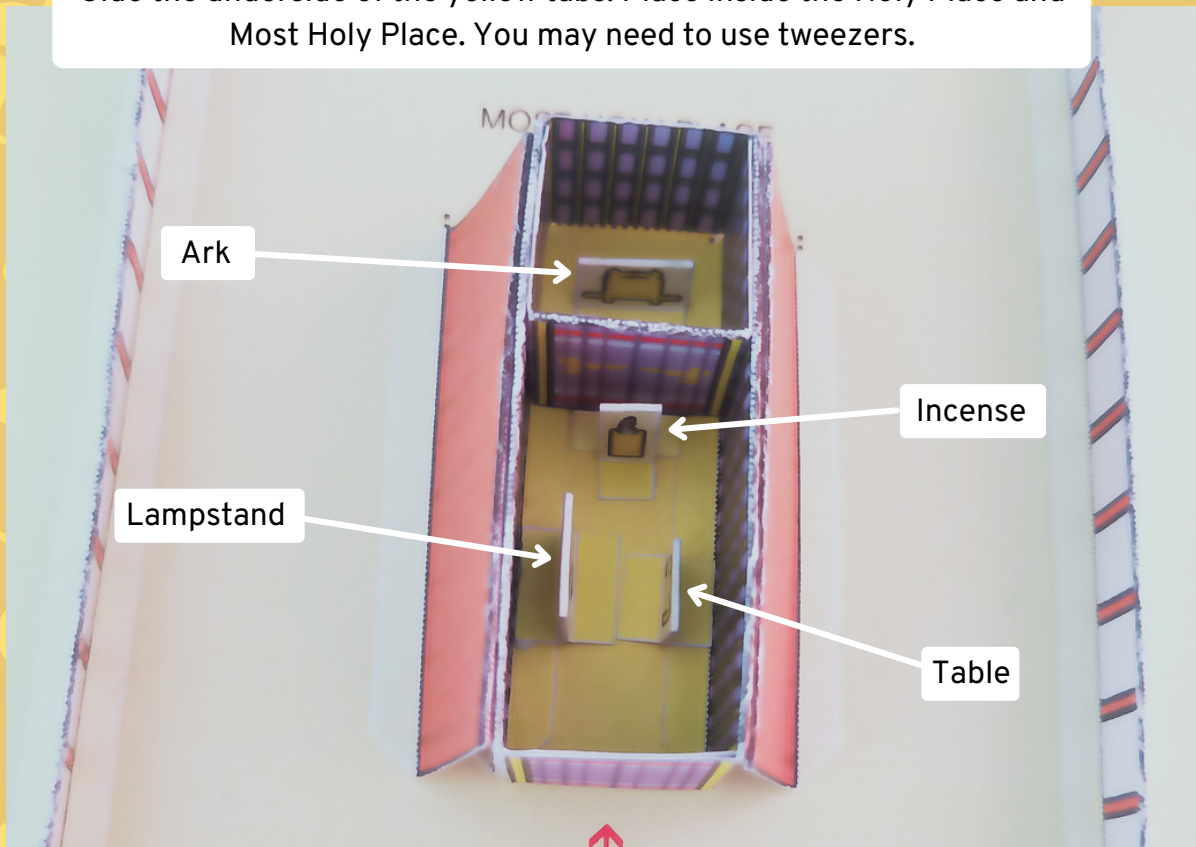

For the altar: bend on each of the dotted lines and fold out the tabs. Make a square and glue the white tab on the inside.

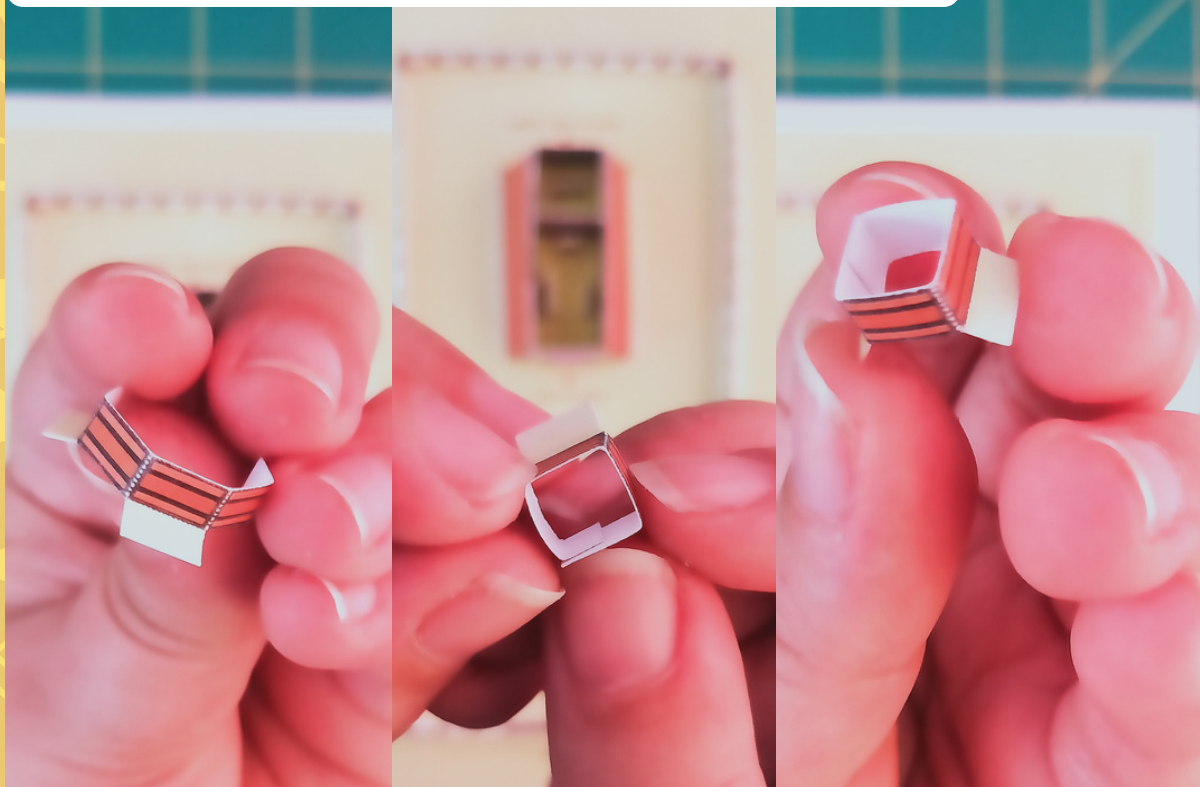

For the fire: fold in half and fold out the tabs. Glue the inside and press together.



Glue the undersides of the tabs on the altar and the fire.
Place carefully on the baseboard, the fire goes inside the altar.



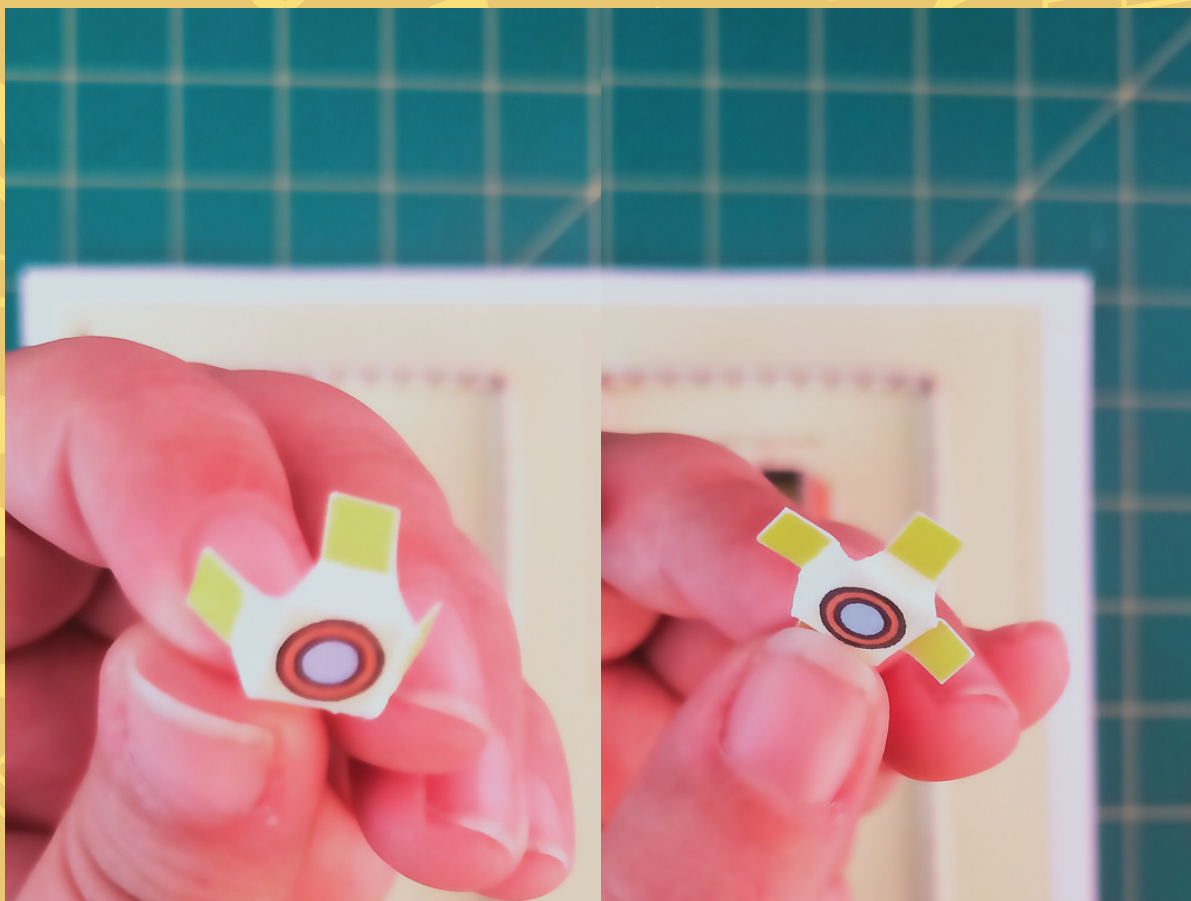

For the basin: Fold down on each side of the basin, then fold out each of the yellow tabs (it will look a bit like a zigzag).

Glue the undersides of the yellow tabs and place carefully on the baseboard.



Ta da, you're finished!!!

